

# Sistem 4600 Glisanta cu ridicare HI (High Insulation)cu BT

## Coeficient de transfer termic

Uw de la 0.9 (W/m²K)

Consultati tipologia, dimensiunea si sticla

## Izolarea acustica

Spatiu maxim pentru vitrare: 55 mm.

Izolarea acustica maxima **Rw=43 dBA**

## Finisaje

Posibilitate bicolor

Culori vopsire (RAL, pestrit si texturat)

Vopsire imitatie lemn

Vopsire antibacteriana

Anodizare

## Categoriile realizate pe bancul de proba

Permeabilitate la aer  
(EN 12207:2000): Clasa 4

Etanseitate la apa  
(EN 12208:2000): Clasa 9A

Rezistenta la vant  
(EN 12210:2000): Clasa C5  
Test de referinta 4.0 x 2.4 m. 2 foi



## Sectiuni

Toc 160.6 mm.

251 mm. 3 cai de rulare

Foaiete 70 mm.

## Lungime bara poliamida

Toc 35 mm.

Foaiete 24 mm.

## Grosime profile

Usa 2,0 mm.

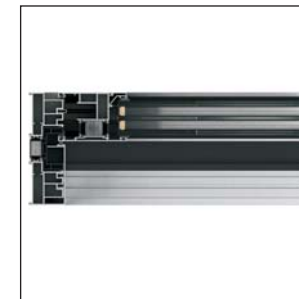
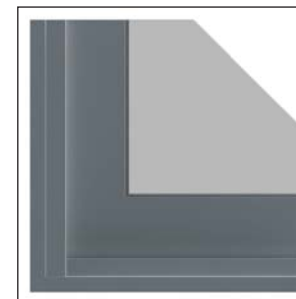
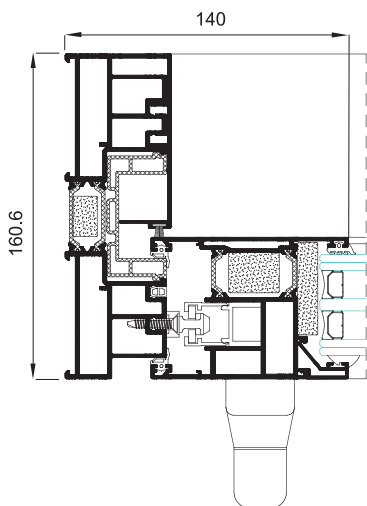

## Posibilitati de deschidere

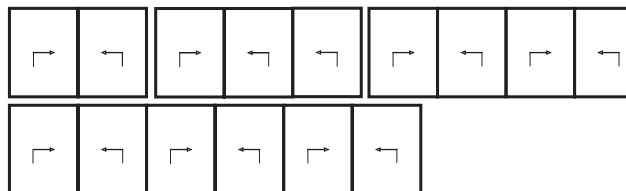

Glisanta de 2, 3, 4 si 6 foi.  
Sistem cu 3 cai de rulare.

## Dimensiuni maxime

Latime(L) = 6.700 mm.

Inaltime (H) = 3.200 mm.

Usa 2 foi

Consultati greutati si dimensiuni maxime pentru celelalte sisteme.

## Greutate maxima/foaie

400 Kg.

