

DP
100

ECONOMY

DP 100 - SYSTEM FEATURES

Sliding and overhead sliding door for external assembly.

The DP 100 system is a modern solution of high quality parameters, based on aluminium structural shapes with a thermal separator.

Photo: Single - family house

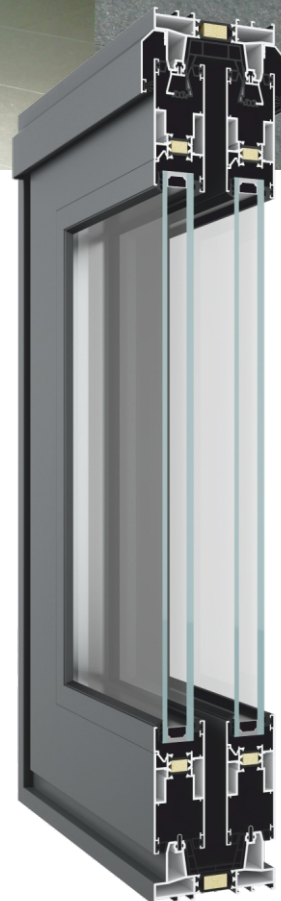

ADVANTAGES OF THE SYSTEM

- possibility of using various types of infills,
- economic solution,
- possibility of creating two- and three-rail constructions,
- possibility of combination with other Yawal systems.

DOOR CROSS - SECTION AT FLOOR LEVEL

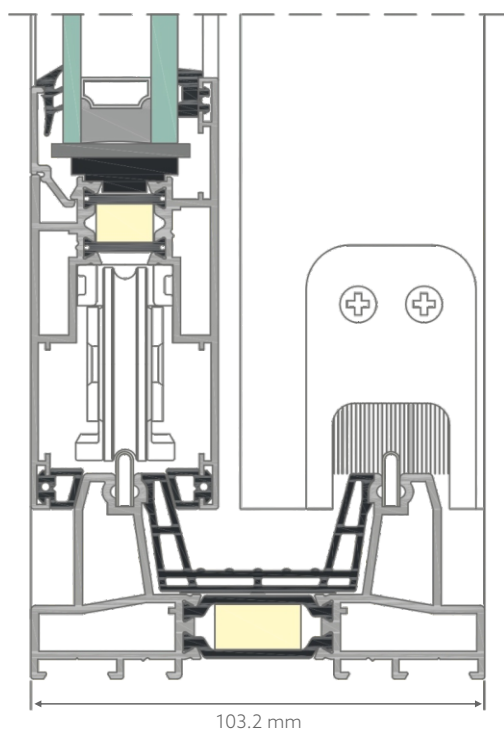

COMBINATION OF LEAFS

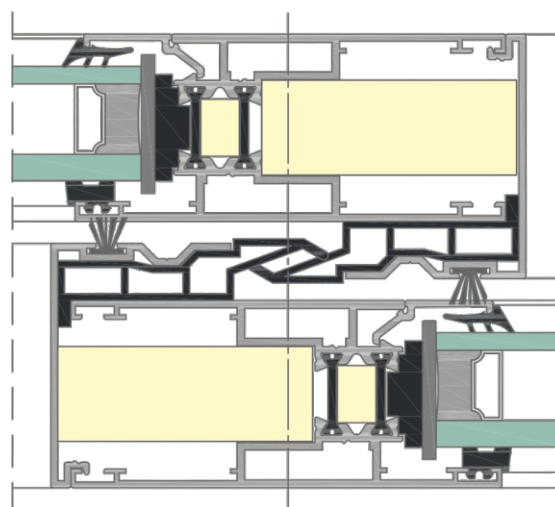

TECHNICAL PARAMETERS - DP 100

Air permeability	class 4 acc. to PN-EN 12207
Water tightness	class 9A acc. to PN-EN 12208
Heat transfer coefficient	$U_f = \text{from } 2,6 \text{ W/m}^2\text{K}$
Wind load resistance	C2 acc. to PN-EN 12210

SYSTEM CHARACTERISTICS

Visible height/width	Lower frame profile	39 mm
	Upper frame profile	27 mm
	Sash profile	96 mm
Structural depth	Frame profile	103,2 mm / 163,8 mm
	Sash profile	42,6 mm
Glazing beam height		22 mm
Glass thickness		14÷28 mm